

Quick Start Guide

Meet Your New SALUS HC Powered Air-Purifying Respirator

salus HC

D O N N I N G , D O F F I N G , A N D P A P R A S S E M B L Y

PARTS LIST

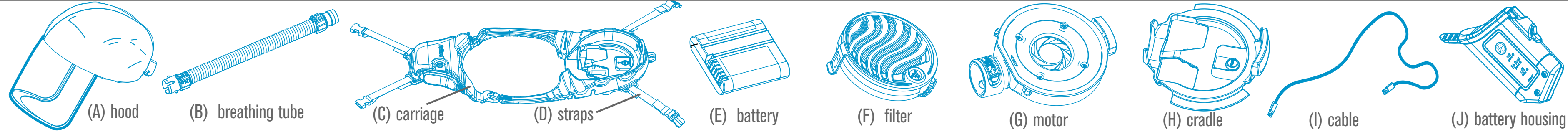

OUT OF THE BOX

NOTE: when using a new battery (E) for the first time, it must be electronically activated for use by inserting it into the charger for several seconds. a new battery (E) will not power the unit until it is activated.

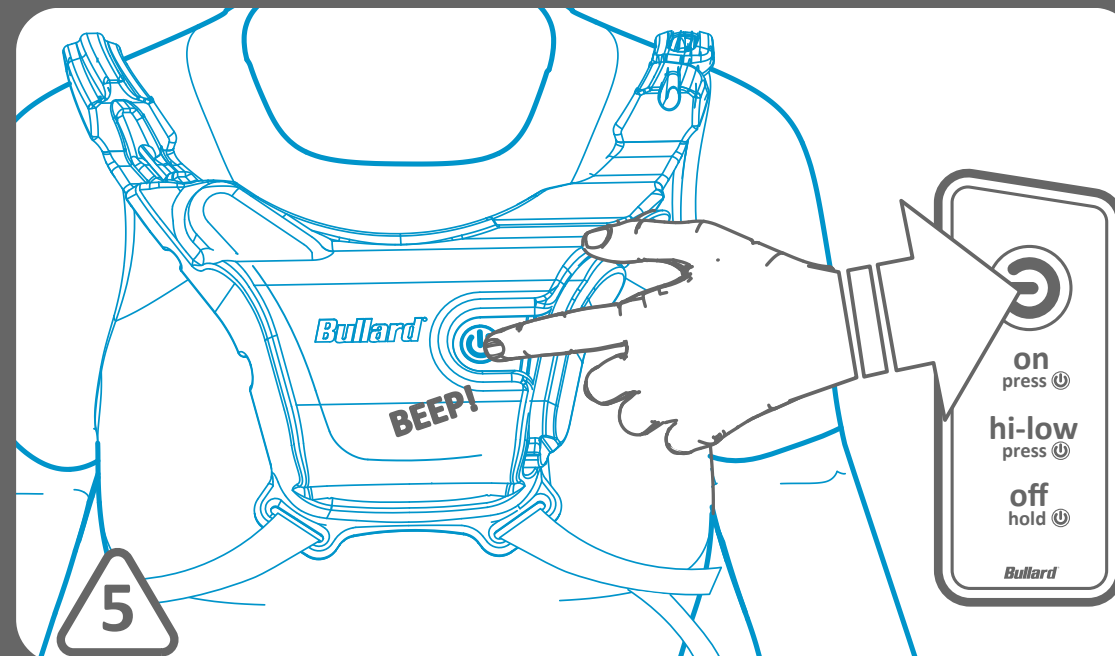
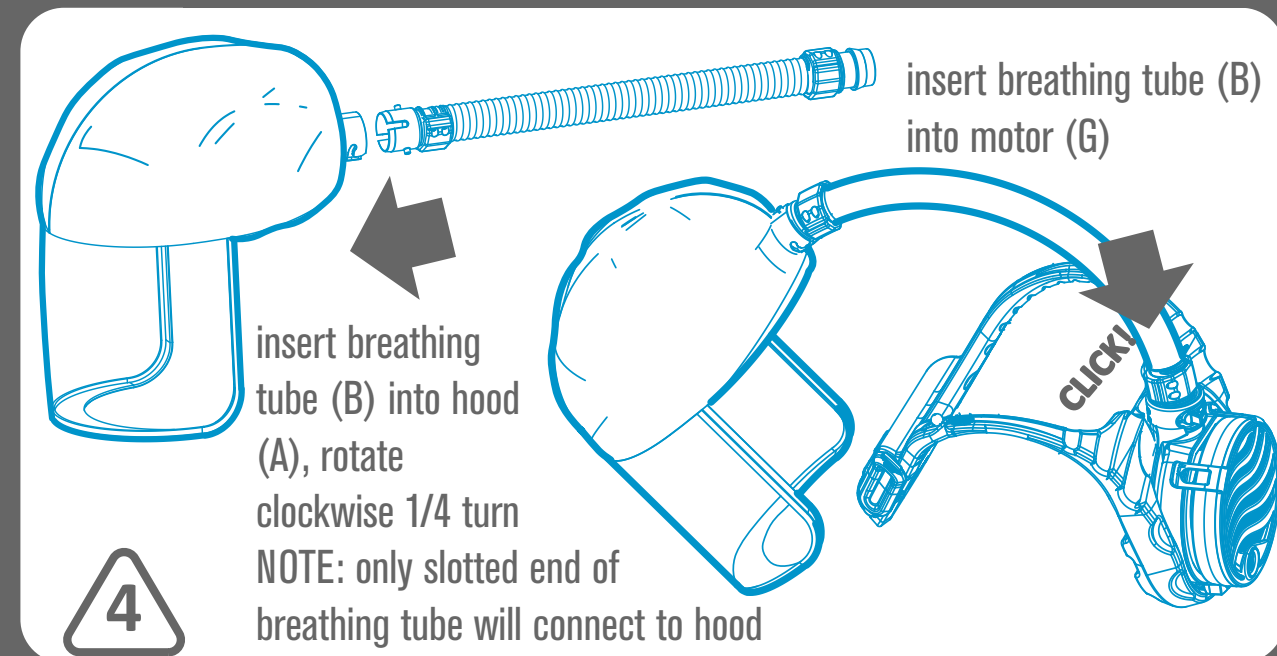
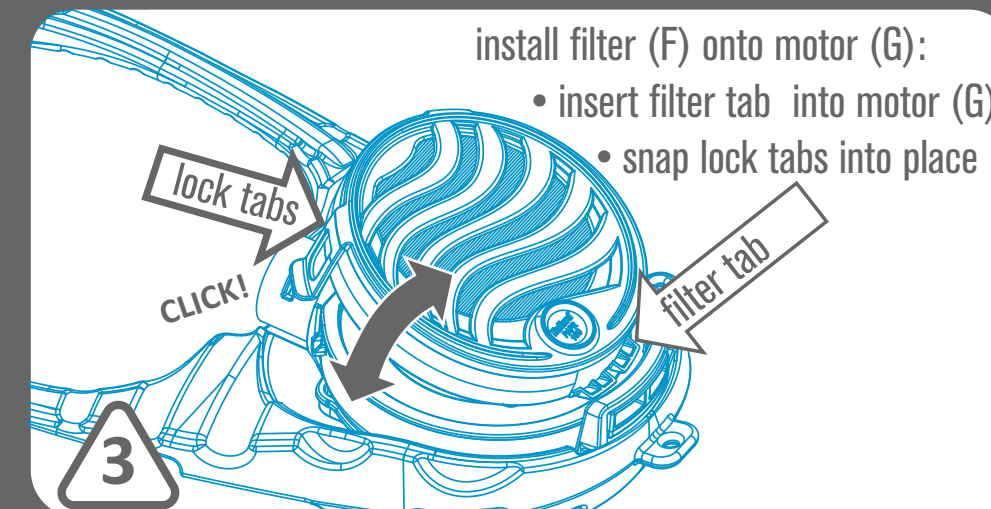
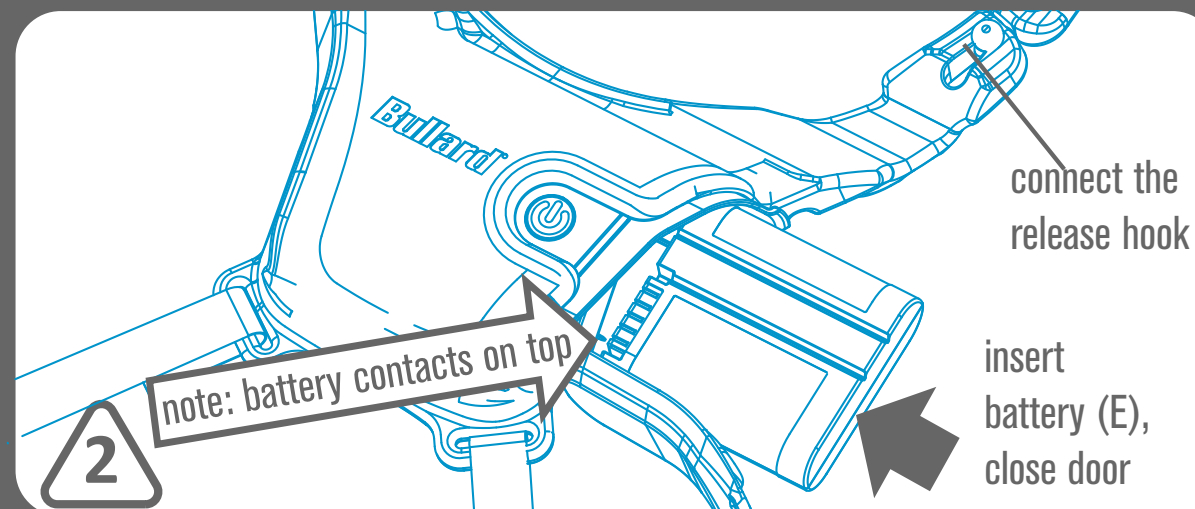
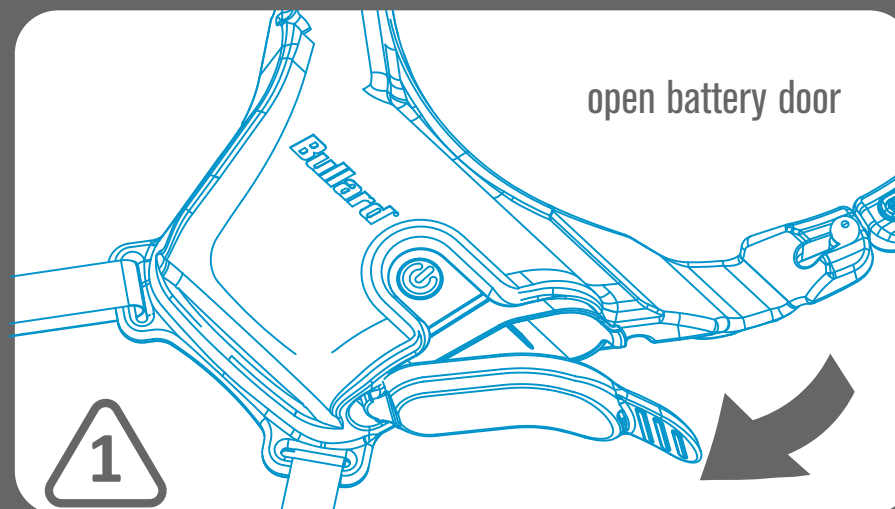

DONNING STEPS:

1. turn unit ON (press button once, turns on in 5 secs)
2. place assembled unit onto shoulders
3. don hood
4. connect body strap buckles, adjust straps
5. press button again to toggle between hi-low

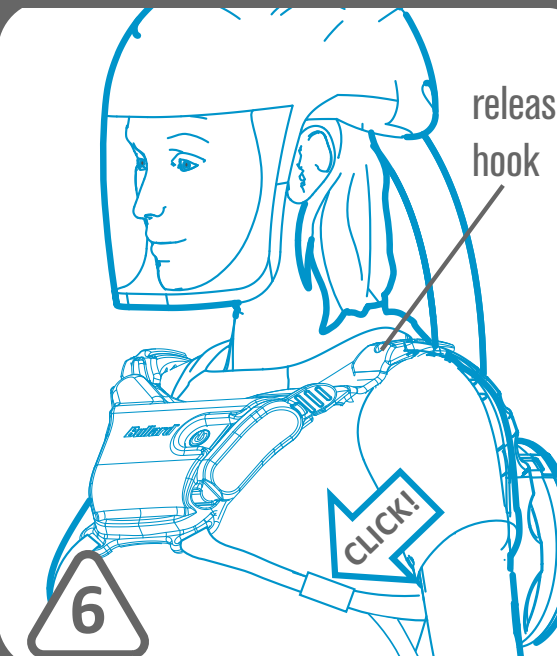

DOFFING STEPS:

1. release body strap buckles
2. disconnect the release hook
3. remove PAPR assembly to right side of your body
4. remove hood
5. turn unit off (hold button)

D I S A S S E M B L E / R E A S S E M B L E P A P R

DISASSEMBLY ORDER

1. REMOVE BATTERY (E)...
open door, remove battery (E)
2. RELEASE LOCK TABS, REMOVE FILTER (F)...
look tabs
3. DISCONNECT/REMOVE CABLE (I) FROM CARRIAGE (C)...
NOTE: when reinstalling cable(I), connect both ends first, starting at battery, tuck cable into carriage slot all the way to motor
4. REMOVE BATTERY HOUSING (J)
lift foam edge with finger, pull out battery housing (J) with opposite hand...
5. REMOVE BREATHING TUBE (B) AND MOTOR (G)...
uninstall: press lever, gently pull breathing tube (B) to remove...
..then, pull motor (G) away from cradle (H) to separate and remove
6. PUSH & HOLD RELEASE BUTTON. PULL CRADLE(H) TO REMOVE

REASSEMBLE IN REVERSE ORDER

6. REPLACE BATTERY (E) AND STRAPS (D)

5. REPLACE FILTER (F) AND STRAPS (D)...

4. RECONNECT CABLE (I) ENDS, INSERT IN CARRIAGE SLOT...

3. REINSTALL BATTERY HOUSING (J)

2. REPLACE MOTOR (G), BREATHING TUBE (B)...

1. REPLACE CRADLE (H)

Your Tools

- Interactive user manual
- Person-to-person, virtual and video training



Scan with any smartphone or visit www.bullard.com/salushc/getstarted

Pre-Inspection

Before donning the PAPR, inspect the entire system (filter, battery pack, loose-fitting hood and breathing tube) for wear and damage, including tears, holes and cracks. Ensure the filter has not exceeded its expiration date. Power the blower on and check the low flow alarm. Simulate a low flow condition by blocking the filter inlet with the palm of one's hand. The blower motor will speed up in an attempt to compensate and shortly after an audible alarm will sound. Remove the obstruction and the alarm will stop once flow is restored. Do not don the PAPR if any parts are missing or damaged, replace them with only SALUS HC Powered Air-Purifying Respirator (PAPR) system replacement parts.

Cleaning, Storage, Disposal

- Clean, dry and inspect prior to each use and before storage.
- Use warm water, mild dishwashing liquid and a soft brush to remove any dirt from exterior surfaces.
- As per CDC guidelines for disinfection, diluted household bleach solutions, alcohol solutions with at least 70% alcohol, and most common EPA-registered household disinfectants should be effective to disinfect exterior surfaces.
- Mechanical laundering of loose-fitting hoods is not recommended.
- Do not immerse equipment in water.
- Damaged or worn-out batteries should be disposed of in accordance with local, state and federal regulations at an approved hazardous waste recycling or disposal facility.
- Used filters and loose-fitting hoods should be disposed of based on the contaminants collected on it and according to local environmental regulations.
- Store PAPR in a clean, dry area.

